

Big BUDDY®

Fiberglass Conduit Rodder

A BUDDY System Product by JAMESON

SPLICING OR ATTACHING NEW END FERRULE

Warning

Read manufacturer's instructions before using adhesive. In case of eye contact, flush with water and seek medical attention. If skin contact occurs, apply solvent (such as nail polish remover) to area and gently remove adhesive. Wash solvent off with water. Solvents should not be used in case of contact with eyes or open wounds.

Always wear safety goggles (ANSI Std. Z87.1) and gloves when working with adhesive and/or unprotected fiberglass rod.

1. Cut away damaged section(s) of fiberglass rod with a fine-tooth hacksaw or sharp knife. Strip protective jacket back about 1-1/4". Do not cut into fiberglass core when stripping jacket. Do not crush fiberglass core.
2. Use emery cloth provided to roughen surface of fiberglass core end (Fig. 1).
3. Clean ends of fiberglass core with a cleaning solvent such as lacquer thinner or denatured alcohol before applying glue.
4. Allow cleaning solvent to evaporate.
5. Apply drop of adhesive to fiberglass core end (in case of a splice, do one end at a time as in Fig. 2A) and spread over core with toothpick or nail.
6. Twist ferrule as you insert rod (Fig. 2A and 2B). Clean off excess glue. Return unused materials to kit.
7. Allow sufficient time for adhesive to dry.

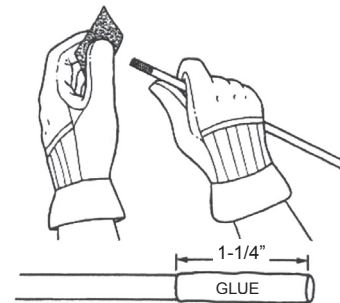

Fig. 1

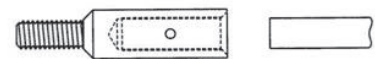

Fig. 2A End Ferrule Repair

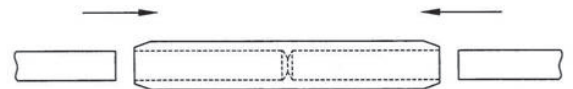

Fig. 2B Splice Repair



800.346.1956
www.jamesonllc.com

BB_SPL_MO1

Connecting Additional Duct Rods

If job requires more rod than is on reel, you can use an additional reel with rod and attach this rod to existing rod:

1. Remove lock nut from rear ferrule and loosen clamp to remove end ferrule from reel.
2. Remove set screw on casting that holds axle in casting.
3. Slide axle out of casting
4. Remove empty reel and install axle in new reel.
5. Re-install axle into casting and tighten set screw.
6. Using Swivel Coupling (Jameson Part # 11-148), attach the beginning of new rod to end of already installed rod.

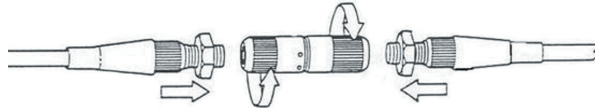

Using Grapples For Long Runs

Another method for rodding long runs is to use Grapples (Jameson Part # 9-148).

1. Attach male grapple to one Big Buddy and rodding duct from one end.
2. Attach female grapple to other Big Buddy and rodding from opposite end of duct.
3. When the two grapples meet, they lock together inside the duct, enable the pull.

Warning: The end of coiled rod is extremely dangerous if released.